



Simple and easy appearance, in line with contemporary aesthetic concept. The product has the structure and appearance design patent. The lamp body adopts high-pressure cast aluminum and aluminum alloy, the surface is coated with outdoor used powder, double anti-corrosion to extend service life. This lawn lamp series uses LED. High efficiency constant current driver, ensure the light source is maximum used.

FIELDS OF APPLICATION

Office & Education, offices, open-plan offices, conference rooms, conference rooms, reception areas, counters, galleries, hotels, restaurants, living spaces

IEC 62717 LED-modules for general lighting – Performance requirements
IEC 62722-2-1 Particular requirements for LED luminaires

High Lumen Efficacy 115lm/W

Body - Die cast aluminum housing with solvent free powder coating

Diffuser - PMMA polycarbonate pattern lens.

Glowing Wire Test - 850°

Temperature - ta=20 °C ~ ta max=50 °C

Class - III

Model --- **NOVA**

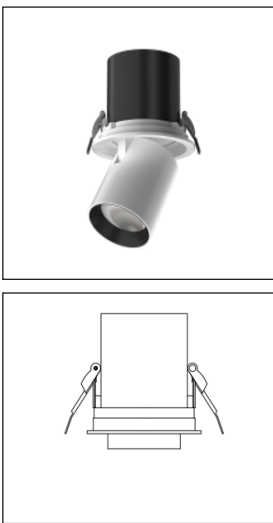

Default Available

NOVA-A-0-15-27-W-6W



Product Assistant Chart

NOVA X X X X X

Size — A — B — C — D —

Driver 0 1 2 3 4
On/Off Dali Dimmable Phase Dimming 1-10

Beam Angle 15° 24° 38° 60°

Kelvin 27 30 40 50 60
2700K 3000K 4000K 5000K 6000K

Finishing W B
white black

Wattage 6 8 10 12 15 20

Lighting Customization Solution; can offer you modifications for environment with higher options as a customized product.

- A - Ø H71-43O-27IN
- B - Ø H78-52O-35IN
- C - Ø H106-100O-72IN
- D - Ø H132-129O-83IN



McA Step 3

220~240V



- 33
- 44
- 88
- 110

Relative spectral perception of brightness and melanopic effect

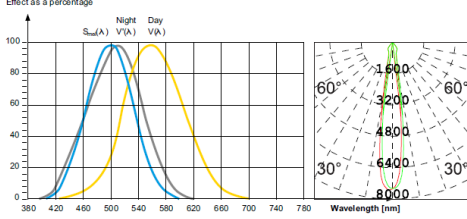

Explanation of the three curves:
V(A) = Perception of brightness, daytime seeing with the cones
V(N) = Nighttime seeing with the rods
S_M(A) = Melatonin suppression with the photosensitive ganglion cells

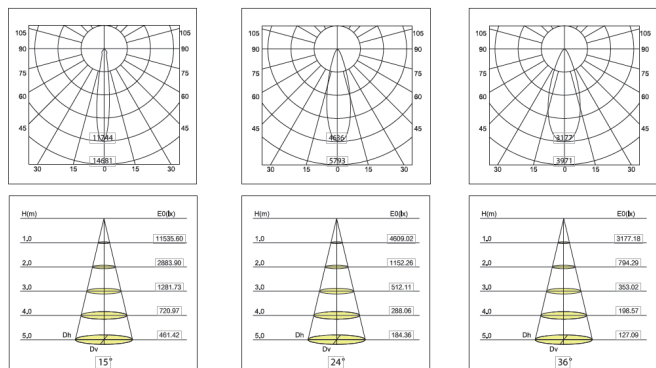

LED life time		Operating time 1,000 h										
Lamp Lumen Maintenance Factor	Lamp Survival Factor	1	10	20	30	40	50	60	70	80	90	100
L80	50,000 h	LLMF	1	0.96	0.92	0.88	0.84	0.80	0.76	0.72	0.68	0.60
		LSF	1	1	1	1	1	0.99	0.99	0.99	0.99	0.98
L80	100,000 h	LLMF	1	0.98	0.96	0.94	0.92	0.90	0.88	0.86	0.84	0.80
		LSF	1	1	1	1	1	1	0.99	0.99	0.99	0.99



LED

CR190

series wiring



LM-80



FLICKER FREE